

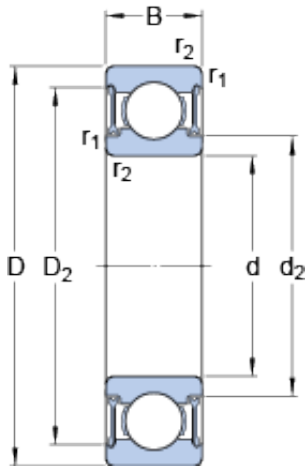

Zotti Industrial Co., Ltd



12 mm x 28 mm x 8 mm SKF W 6001-2RZ deep groove ball bearings

Bearing No. W 6001-2RZ

W 6001-2RZ Bearing 2D drawings and 3D CAD models

Size	28x12x8 mm
Bore Diameter	28 mm
Outer Diameter	12 mm
Width	8 mm
d	12 mm
D	28 mm
B	8 mm
d ₂	16 mm
D ₂	25.15 mm
r _{1,2} - min.	0.3 mm
D _a - max.	26 mm
r _a - max.	0.3 mm
Basic dynamic load rating - C	4.4 kN
Basic static load rating - C ₀	2.4 kN
Fatigue load limit - P _u	0.102 kN
Reference speed	60000 r/min
Limiting speed	30000 r/min
Calculation factor - k _r	0.03
Calculation factor - f ₀	13.2
d ₂	16 mm
D ₂	25.15 mm
r _{1,2} min.	0.3 mm
d _a min.	14 mm
d _a max.	15.5 mm



Zotti Industrial Co., Ltd

D_a max.	26 mm
r_a max.	0.3 mm
Basic dynamic load rating C	4.42 kN
Basic static load rating C_0	2.36 kN
Fatigue load limit P_u	0.102 kN
Calculation factor k_r	0.03
Calculation factor f_0	13.2
Mass bearing	0.02 kg